

Passive Gain Block



Features

- ◇ Compact
- ◇ Wide Operating Wavelength
- ◇ Flat Gain
- ◇ High Efficiency
- ◇ Low Noise Figure

Application

- ◇ Post, Pre, Line Amplifier for DWDM
- ◇ C-band, L-band EDFA

Fujikura's Passive Gain Block is a compactly packaged optical module for DWDM, which is composed of an EDF, a GFF, a pump-signal WDM, optical isolators, a tap coupler and etc., except pumping LDs. Based on Fujikura's technology of passive optical components, high performance is achieved.

Parameters	Unit	Performance (Example)	
		Pre-Amplifier	Post-Amplifier
Application Type	-	Pre-Amplifier	Post-Amplifier
Wavelength	nm	1528 – 1565	
Number of Input Channel	ch	1 – 32	
Signal Input Power	dBm/ch	-15	-14
Gain	dB	15	20
Signal Output Power	dBm/ch	0	6
Gain Flatness	dB	< 1.0	< 1.0
Noise Figure	dB	< 5.5	< 13.5
Pump Wavelength	nm	974 – 976	1460 – 1490
Number of Pump Port	-	1	2
Pump Power for Pump Port	mW/port	< 200	< 200

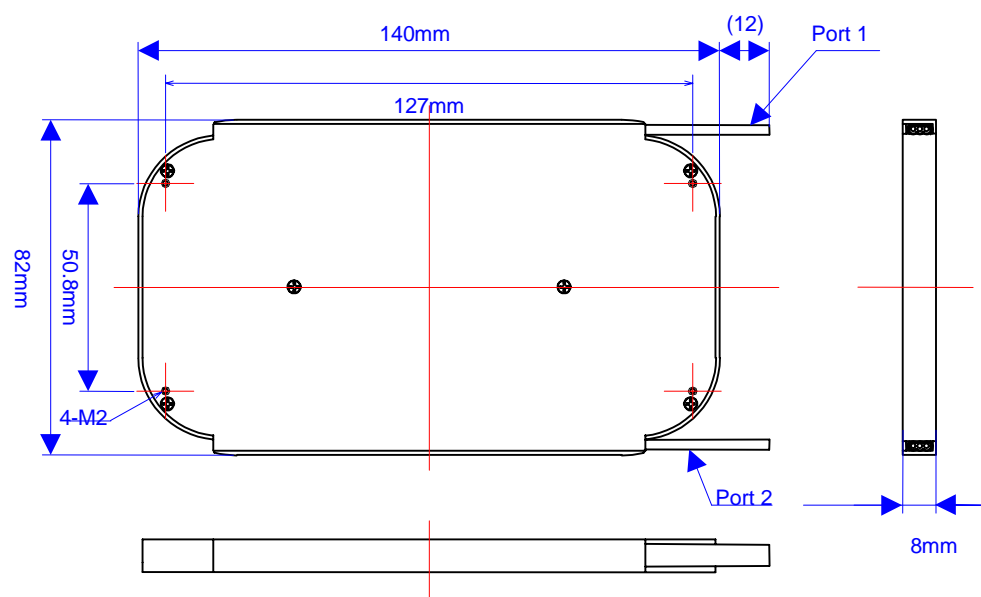

Typical Gain Spectrum

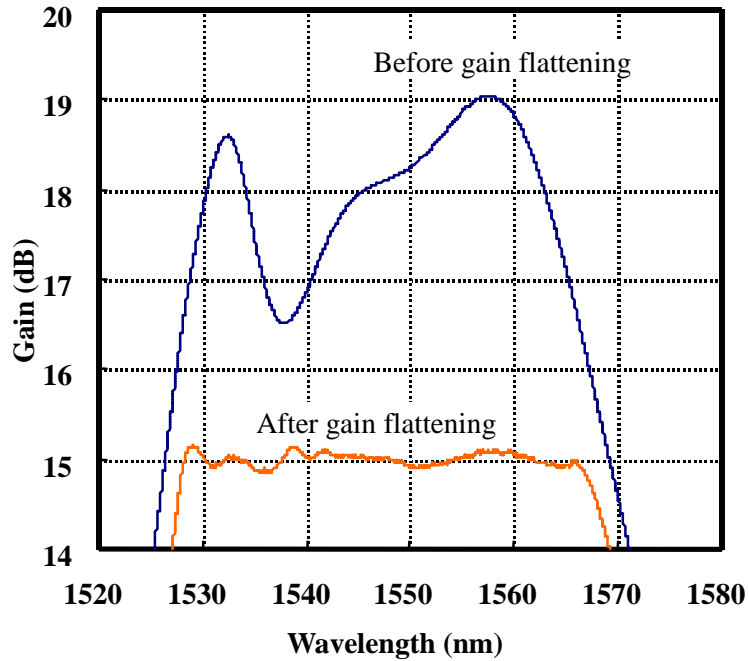

We can provide Semi-Assy Gain Block by combining our optical device products for your specification
Please ask to us about combination of optical devices and characteristics

